

Our Ref. : DD94 Lot 424 RP
Your Ref. : TPB/A/NE-KTS/566

The Secretary,
Town Planning Board,
15/F, North Point Government Offices,
333 Java Road,
North Point, Hong Kong

By Email

10 September 2025

Dear Sir,

Supplementary Information

Proposed Temporary Warehouse (Excluding Dangerous Goods Godown) with Ancillary Facilities and Associated Filling of Land for a Period of 3 Years in "Agriculture" Zone, Lot 424 RP (Part) in D.D. 94, Kwu Tung South, Sheung Shui, New Territories

(S.16 Planning Application No. A/NE-KTS/566)

We are writing to submit supplementary information in support of the subject application, details are as follows:

Filling of Land

- The application site (the Site) has already been hard-paved. The current application serves to regularize the existing land filling work to reflect the existing condition of the Site. The applicant will strictly follow the proposed scheme, no further filling of land will be carried out during the planning approval period.

Ancillary Facilities

- The ancillary site office and washroom will be provided within structure B1 (**Plan 1**)

Operation Details

- All goods will be stored within enclosed structures. No open storage activities will be carried out within the Site at any time during the planning approval period.

Parking and Loading/Unloading Provision

- Only private car and light goods vehicle (i.e. gross weight of not more than 5.5 tonnes) are allowed to enter/exit the Site at any time during the planning approval period.





R-RICHES
PLANNING LIMITED

Should you require more information regarding the application, please contact our Mr. Danny NG at [REDACTED] or the undersigned at your convenience. Thank you for your kind attention.

Yours faithfully,

For and on behalf of
R-riches Planning Limited

Louis TSE
Town Planner



DEVELOPMENT PARAMETERS

| | | |
|-----------------------|----------------------|---------|
| APPLICATION SITE AREA | : 853 m ² | (ABOUT) |
| COVERED AREA | : 457 m ² | (ABOUT) |
| UNCOVERED AREA | : 396 m ² | (ABOUT) |
| PLOT RATIO | : 0.54 | (ABOUT) |
| SITE COVERAGE | : 54 % | (ABOUT) |
| NO. OF STRUCTURE | : 2 | |
| DOMESTIC GFA | : NOT APPLICABLE | |
| NON-DOMESTIC GFA | : 457 m ² | (ABOUT) |
| TOTAL GFA | : 457 m ² | (ABOUT) |
| BUILDING HEIGHT | : 13 m | (ABOUT) |
| NO. OF STOREY | : 1 | |

| STRUCTURE | USE | COVERED AREA | GROSS FLOOR AREA | BUILDING HEIGHT |
|-----------|---|----------------------------|----------------------------|------------------------|
| B1 | WAREHOUSE (EXCLUDING D.G.G.), SITE OFFICE AND WASHROOM | 228 m ² (ABOUT) | 228 m ² (ABOUT) | 13 m (ABOUT)(1-STOREY) |
| B2 | WAREHOUSE (EXCLUDING D.G.G.), | 229 m ² (ABOUT) | 229 m ² (ABOUT) | 13 m (ABOUT)(1-STOREY) |
| TOTAL: | | 457 m ² (ABOUT) | 457 m ² (ABOUT) | |

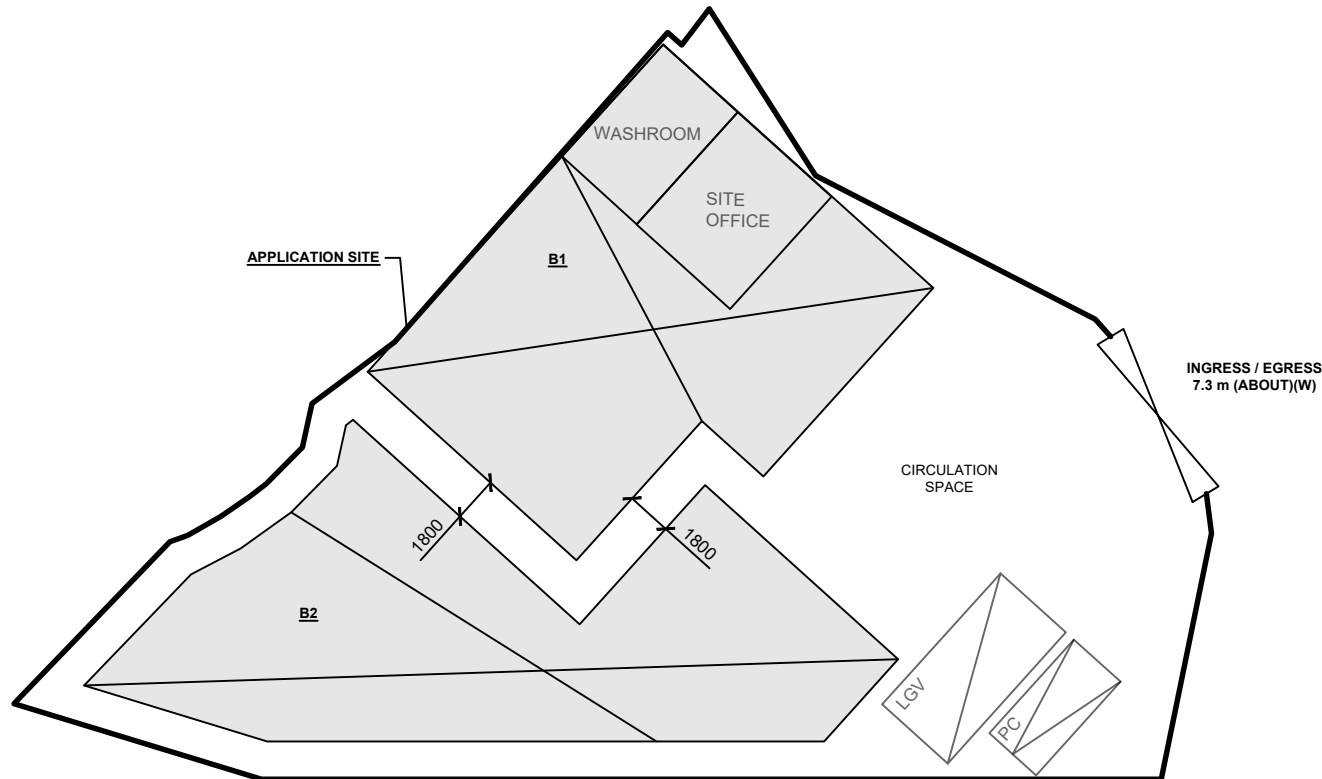
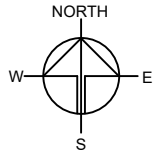

PARKING AND LOADING/UNLOADING PROVISION

| | |
|--|-----------------------|
| NO. OF PRIVATE CAR PARKING SPACE | : 1 |
| DIMENSION OF PARKING SPACE | : 5 m (L) X 2.5 m (W) |
| NO. OF LIGHT GOODS VEHICLE PARKING SPACE | : 1 |
| DIMENSION OF LOADING/UNLOADING SPACE | : 7 m (L) X 3.5 m (W) |

SITE BOUNDARY FOR IDENTIFICATION PURPOSE ONLY.

LEGEND

| | |
|--|---------------------------------|
| | APPLICATION SITE |
| | STRUCTURE |
| | PARKING SPACE (PC) |
| | LOADING / UNLOADING SPACE (LGV) |
| | INGRESS / EGRESS |

PLANNING CONSULTANT



PROJECT

PROPOSED WAREHOUSE (EXCLUDING DANGEROUS GOODS GODOWN) WITH ANCILLARY FACILITIES AND ASSOCIATED FILLING OF LAND FOR A PERIOD OF 3 YEARS

SITE LOCATION

LOT 424 RP (PART) IN D.D. 94, KWU TUNG SOUTH, SHEUNG SHUI, NEW TERRITORIES

SCALE

1 : 500 @ A4

| | |
|-------------|-----------|
| DRAWN BY | DATE |
| MN | 19.8.2025 |
| CHECKED BY | DATE |
| APPROVED BY | DATE |

DWG. TITLE
LAYOUT PLAN

| | |
|---------|------|
| DWG NO. | VER. |
| PLAN 1 | 001 |